



12 100 9120 TMS

---

# **Advance Valves High Performance Butterfly Valves**

---

**Series BD - BT - BP**

---

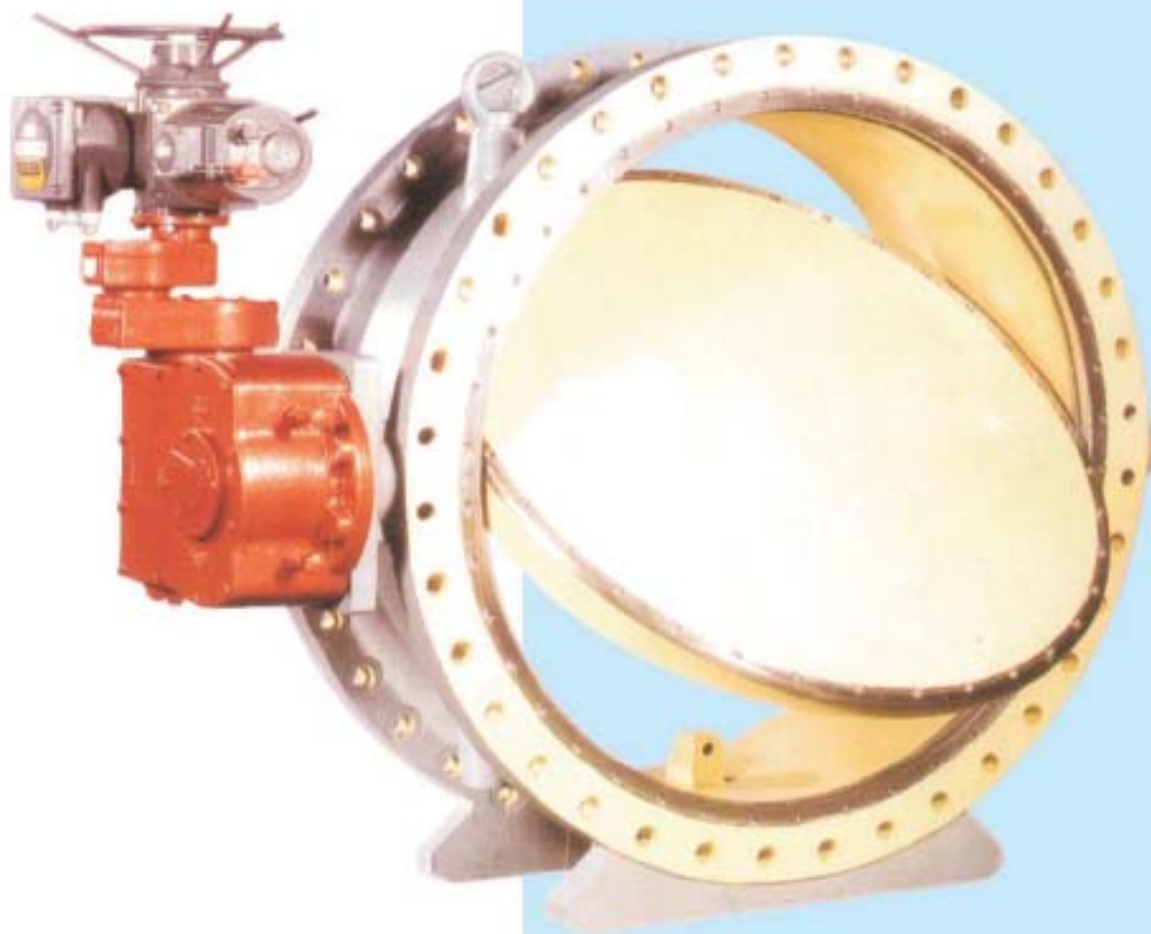

**CE**  
**0062**

---

**ADVANCE VALVES**  
**PRIVATE LIMITED**

---

# TECHNICAL DATA

Fully Flanged  
PN10, PN16 & Pn25

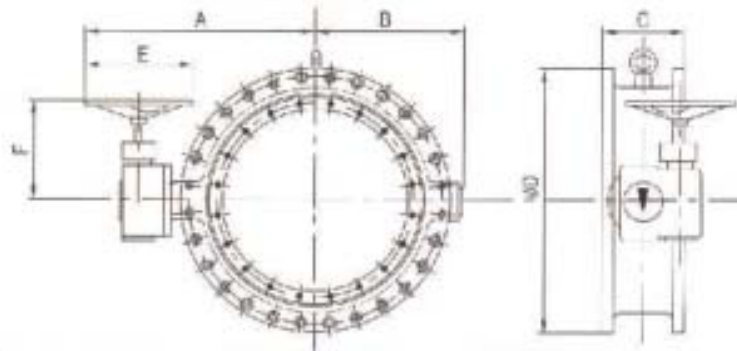

SIZE (MM)	PN10							PN16							PN25						
	A	B	C	D	E	F	WEIGHT (kg)	A	B	C	D	E	F	WEIGHT (kg)	A	B	C	D	E	F	WEIGHT (kg)
300	435	270	178	415	250	200	121	455	275	178	460	250	200	123	575	285	178	465	450	310	260
350	515	295	190	505	350	205	159	535	305	190	520	350	205	176	610	325	190	555	450	310	365
400	500	325	216	565	250	290	214	600	325	216	500	450	310	213	645	355	216	620	350	295	450
450	590	322	216	350	295	238	255	305	222	640	650	350	295	422	705	385	222	670	450	310	530
500	675	390	229	670	450	310	305	733	390	229	715	450	310	469	750	415	229	730	450	330	649
600	715	435	267	760	350	285	433	795	455	267	840	450	330	660	840	475	267	845	450	380	910
700	820	495	292	895	450	330	633	915	500	292	910	600	360	803	985	525	292	960	600	410	1200
800	825	555	318	1015	450	300	845	945	580	318	1025	450	380	1070	1065	590	318	1085	600	440	1621
900	970	610	330	1115	450	365	1194	1040	620	330	1125	600	440	1607	1125	650	330	1185	600	440	2300
1000	1090	695	410	1230	450	400	1632	1100	685	410	1255	450	480	2035	1120	715	410	1320	450	595	2925
1200	1265	795	470	1455	600	440	2150	1340	800	470	1485	600	510	2500	1400	820	470	1530	600	625	3350
1400	1340	920	530	1675	600	520	3510	1390	940	530	1685	600	615	4210	1465	975	530	1755	600	615	5475
1600	1460	1040	600	1915	600	520	5320	1500	1060	600	1930	600	615	6380	1585	1085	600	1975	600	615	8295
1800	1630	1170	670	2115	600	615	6200	1750	1190	670	2130	600	735	7440	1945	1220	670	2185	750	735	9670
2000	1740	1270	760	2325	600	615	7300	1860	1290	760	2345	600	735	9125	2055	1330	760	2425	750	945	11660
2200	1935	1395	870	2550	600	615	8500	2025	1400	870	2555	600	765	10625							
2400	2040	1500	980	2760	600	615	10000	2130	1505	980	2765	600	765	12515							
2600	2305	1600	1110	2950	750	765	11960														
2800	2435	1710	1240	3380	750	765	14230														
3000	2750	1825	1400	3405	750	970	17080														

SPECIAL SIZES  
AVAILABLE ON REQUEST

WAFFER PN10, PN16 & PN25

LUGGED PN10, PN16 & PN25

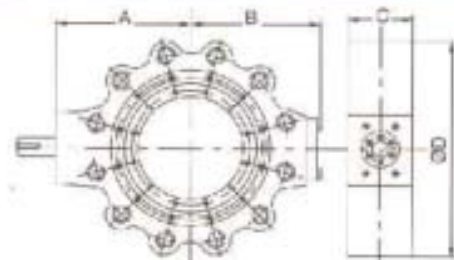
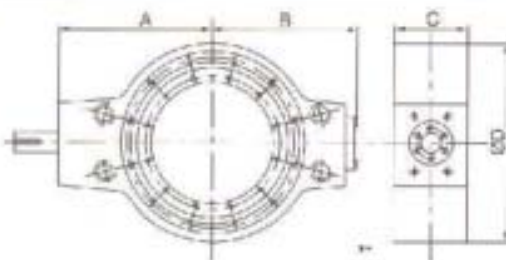

SIZE (MM)	PN10							PN16							PN25						
	A	B	C	D	WEIGHT (kg)	(kg) LUGGED	A	B	C	D	WEIGHT (kg)	(kg) LUGGED	A	B	C	D	WEIGHT (kg)	(kg) LUGGED			
60	120	110	64	135	11	19	120	110	64	135	11	19	145	140	64	135	11	19			
100	130	120	64	155	12	20	130	120	64	155	12	20	155	145	64	160	13	22			
150	170	145	76	210	23	29	170	145	76	210	23	29	190	175	76	215	24	32			
200	200	160	89	265	33	52	200	190	89	265	33	52	230	205	89	275	35	55			
250	230	220	114	320	43	75	230	220	114	320	44	77	270	255	114	335	79	61			
300	275	250	114	370	75	102	275	250	114	370	80	105	315	295	114	395	85	110			
350	260	270	127	430	90	125	280	270	127	435	96	142	350	325	127	450	102	159			
400	330	300	140	480	107	142	330	300	140	480	121	175	385	360	140	505	136	198			
450	370	340	152	530	125	160	380	360	152	545	145	196	420	385	152	555	161	226			
500	360	345	152	585	169	200	420	385	152	610	184	231	455	415	152	615	197	251			
600	440	415	176	685	198	250	500	470	176	725	242	298	525	475	176	725	258	312			

OTHER SIZES AND PRESSURES AVAILABLE ON REQUEST

Advance Gunric is the leader in the manufacture of high performance valves, offering a comprehensive range of elastomers, PTFE and metal-seating valves.

Butterfly valves are manufactured in sizes from 80 millimetres to 2.5 metres, with models pressure rated from 10 to 160 Bar.

Butterfly valves are available in wafer, lug-type and fully flanged configurations.

Flange drilling can accommodate BS 4504, DIN 2631/2/3/4 as well as ANSI B 16.5, ANSI B 16.47 (A), API 605 (A), AWWA C207, IS 6392 and IS 1538.

Elastomer-seal valves operate on the double off-set principle and are pressure rated up to 25 Bar. Pressures of up to 160 Bar can be achieved by metal and PTFE-seated valves operating on the Tricentric design principle.

**ELASTOMETER SEAL BD  
DOUBLE OFF-SET**

**METAL TO METAL SEAL BT  
TRIPLE OFF-SET**

**P.T.F.E. SEAL BP  
TRIPLE OFF-SET**

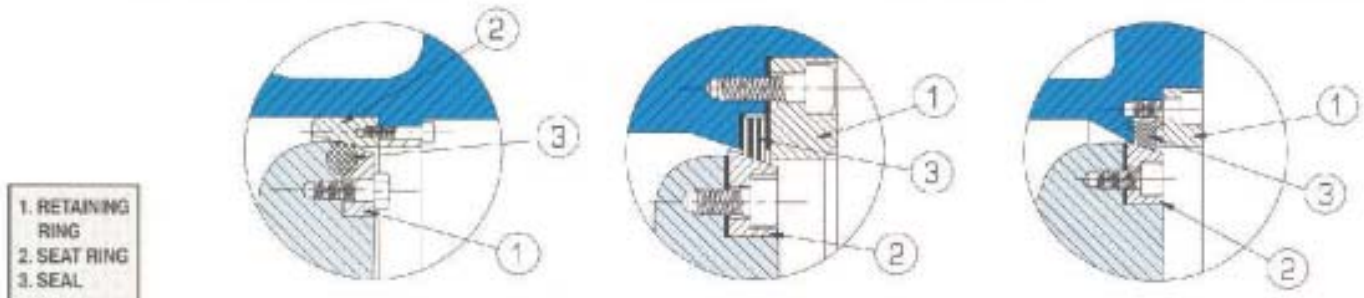

**DOUBLE OFF-SET VALVE**

**TRIPLE OFF-SET VALVE**

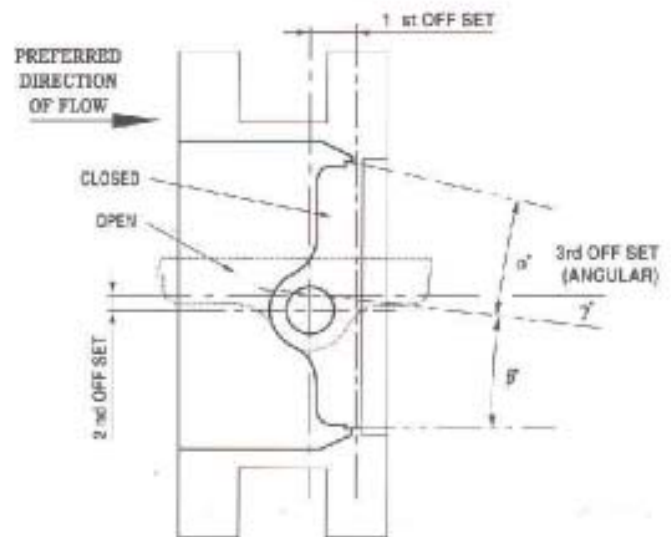
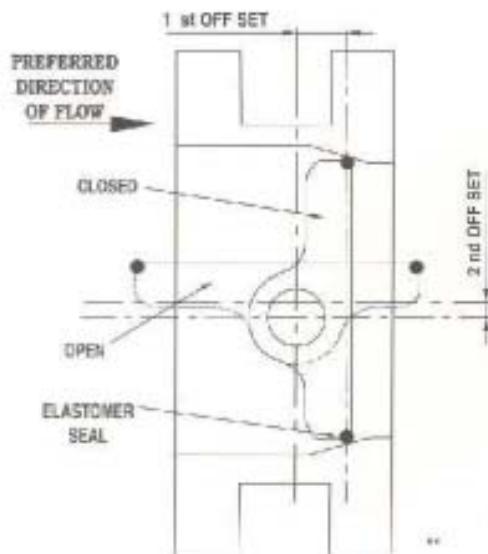

**Materials :**

Body and Disc: Fabricated Carbon Steel, Cast Iron, Cast Steel, Stainless Steel, Titanium, Nickel Alloys to ASTM/BS/IS standards.

Shaft: Stainless Steel 431 (EN57), A/SI 410, Monel, 17-4-PH, Duplex, Super Duplex, Inconel, Titanium

Bearing Bush: Glacier Du, Deva, Stellite, Nitrided Stainless Steel.

Seals: Nitrile, Buna N, Viton, PTFE, Laminated/ Solid Stainless Steel, Duplex, Super Duplex, Inconel, Titanium.

Retaining & Seat Ring: SS - 304, SS - 316, SS - 410/431, Monel, Duplex, Super Duplex, Inconel, Titanium.

Actuation: Advance Gunric valves are generally fitted with worm gearboxes for manual operation. They can be fitted with Electric, pneumatic or hydraulic actuators to suit output drives in accordance with ISO 5211.

# ADVANCE VALVES PRIVATE LIMITED

**GUNRIC** has, over a period of years, established a reputation for manufacturing high technology valves. Their range of triple and double offset butterfly valves are manufactured in sizes from 80 mm to 2500 mm and pressure from 10 Bar (class 125) to 160 Bar (Class 900).

Advance Gunric Valves is a joint venture company between Advance Valves Group, India and Gunric Valves, S.A. The company is based in India and acting as global sourcing centre for butterfly valves.

The Gunric range of valves are in use at many of the Water Boards, Water Authorities, Municipalities, Mines, Petroleum and Process plants, and Steel refineries in South Africa, as well as Europe and the Far East.

The Valves are available in wafer, lugged and double flanged configurations. A wide variety of drilling can be accommodated as well as most European, American and Asian Specifications.

## Our Commitment to Quality

At Advance Gunric we recognise that constant high quality is essential to meet today's arduous service requirements in the valve industry.

Gunric operates a quality system according to ISO 9001 & according to European Pressure Equipment directive 97/23/EC, Module H to use CE 0035 monogram accredited by TUV Rheinland.

We believe that on going research and development is important and constantly strive to improve the technology and quality of our valves.



32" Class 300 Emergency Shut-off valve



1400 mm valve in operation in a platinum smelter

## TYPICAL FINITE ELEMENT STRESS ANALYSIS

### Deflection of a DN 2000 Pn10 Disc



Machining of valve components by CNC machine

<i>Manufactured &amp; Marketed by :</i>	<i>Represented by :</i>
<p><b>ADVANCE GUNRIC</b>          INDIA • USA • UK • UAE • SINGAPORE • SOUTH AFRICA • QATAR  <b>ADVANCE VALVES PVT. LTD.</b>          Head Office : B-33, Sector-2, Noida-201 301 (INDIA)          Tel : +91(120) 2523395 / 2528439, Fax : +91(120) 2553225, (From Delhi Dial 95120)          email : communications@advancevalves.com website : www.advancevalves.com</p>	